

Japanese Art & Cultural Center

4334 Moorpark Ave.

San Jose, CA 95129

TEL: (408)418-3535

EMAIL: staff@jpnarts.org

WEB: www.jpnarts.org



PROJECT PROPOSAL

Japanese Rock Garden **at the Strawberry Park Shopping Center**

*Dedicated to the victims of the 2011 Japanese Earthquake and Tsunami
and the Americans who assisted them*

Revision History

Date	Version	Description	Author
5/4/2011	1.0	First Draft	Akihiro Omi
5/4/2011	1.1	Proofread	Bruce Mendenhall
5/8/2011	2.0	Corrected typos and updated layout	Akihiro Omi
6/24/2011	3.0	Updated layout and added plaque	Akihiro Omi
8/15/2011	4.0	Added the donation form	Akihiro Omi

Table of Contents

1. PROJECT SUMMARY	Page 3
1.1 Purpose	Page 3
1.2 Goals	Page 3
2. COST	Page 3
3. CONSTRUCTION PERIOD	Page 3
4. ILLUSTRATIONS & DRAWING	Pages 4 - 6
5. IMAGE PHOTOS	Page 7
6. ASSUMPTIONS & REQUIREMENTS	Page 8
7. DONATIONS & BRONZE PLAQUES	Page 8
8. CONTACTS	Page 9
DONATION FORM	Page 10

1. PROJECT SUMMARY

This project is to build a Japanese Rock Garden in San Jose at the Strawberry Park Shopping Center, which houses Mitsuwa, the largest Japanese grocery store in Northern California, Kinokuniya Bookstore, Tomi Sushi, Clover Japanese Bakery, Kahoo Ramen, Shabuway, and Japanese Art & Cultural Center.

Japanese rock gardens are gardens with dry landscape; no plants, trees or water is used. The gardens are symbolic representations of natural landscapes using rock arrangements, and are regarded as works of art. The gardens and surrounding space provide visitors with serenity, tranquility and peace of mind. Although such gardens are often found in Japanese Zen temples, they are considered artistic creations without any particular religious significance.

1.1 Purpose

The Japanese rock garden at the Strawberry Park Shopping Center should be built as a landmark attraction characterizing, and differentiating, the Asian-themed Shopping Center. The surrounding areas would offer shoppers and visitors comfortable space to gather, rest, talk or eat. The garden itself is work of art as well as a monument dedicated to the victims of the 2011 Japanese Earthquake and Tsunami disasters as well as their American neighbors and friends who provided assistance.

1.2 Goals

- To express the Japanese people's gratitude toward the American public, neighbors across the Pacific, for their warm and kind support and generous assistance for the victims of the 2011 Earthquake and Tsunami.
- International exchange of friendship and goodwill in the grass-roots (community) level.
- To provide artistic ambience and quiet space for community members at large, as well as meeting & resting space for shoppers.
- To help promote the traditional Japanese culture, arts and philosophies.

2. COST

The initial construction cost estimate is \$20,000. The entire amount is to be raised by the local Japanese communities, businesses and corporate partners.

3. CONSTRUCTION PERIOD

Construction of the Japanese Rock Garden is expected to start in the beginning of September 2011, and is expected to take 4 weeks.

4. ILLUSTRATIONS & DRAWING

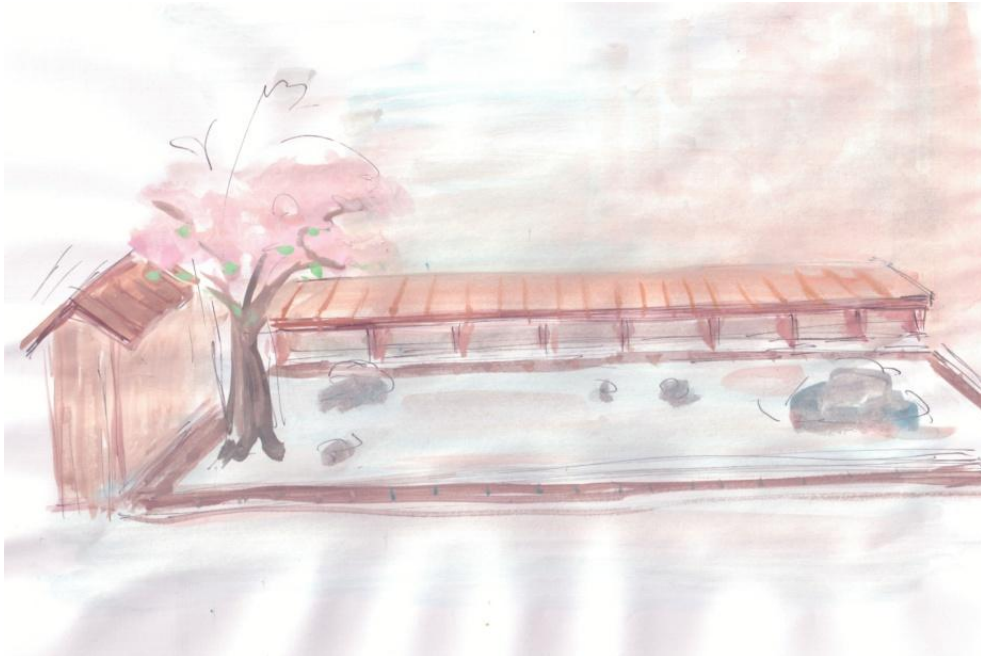
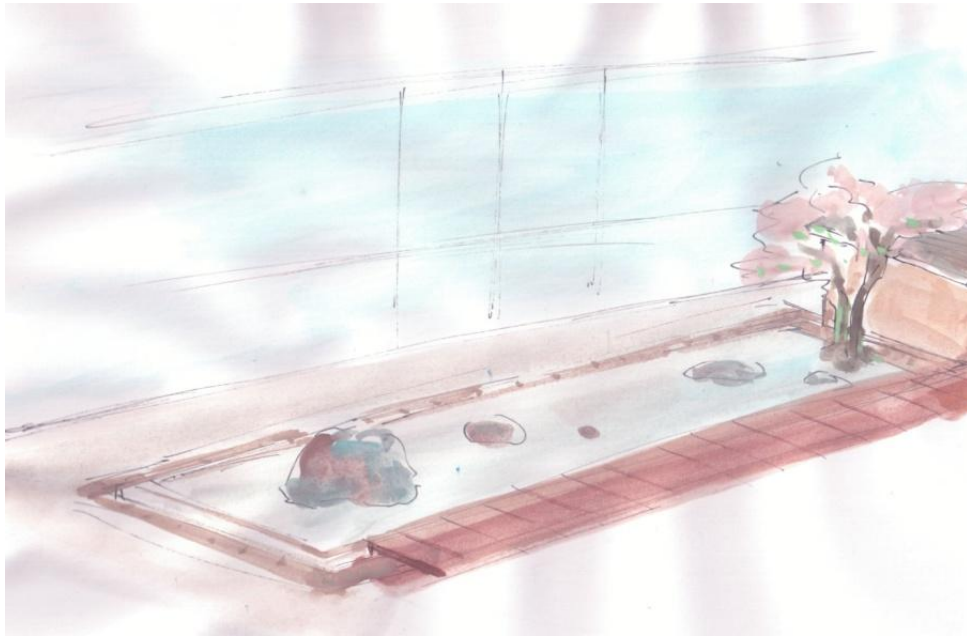

Project	Site Plan: Descriptions	Sheet Rev.	1.1
	Japanese Stone (Rock) Garden at the		
	Strawberry Park Shopping Center, San Jose	Sheet	1 of 2

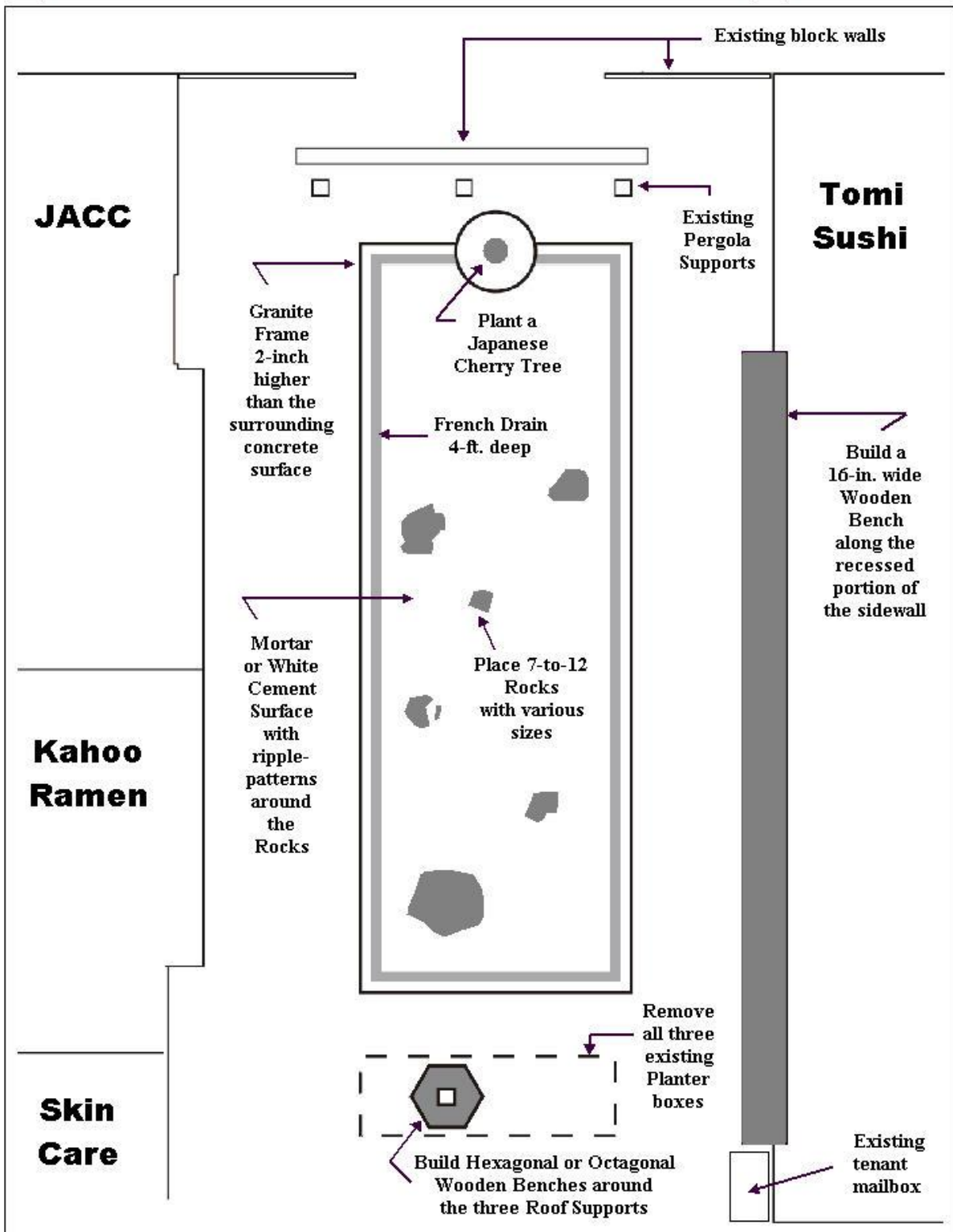

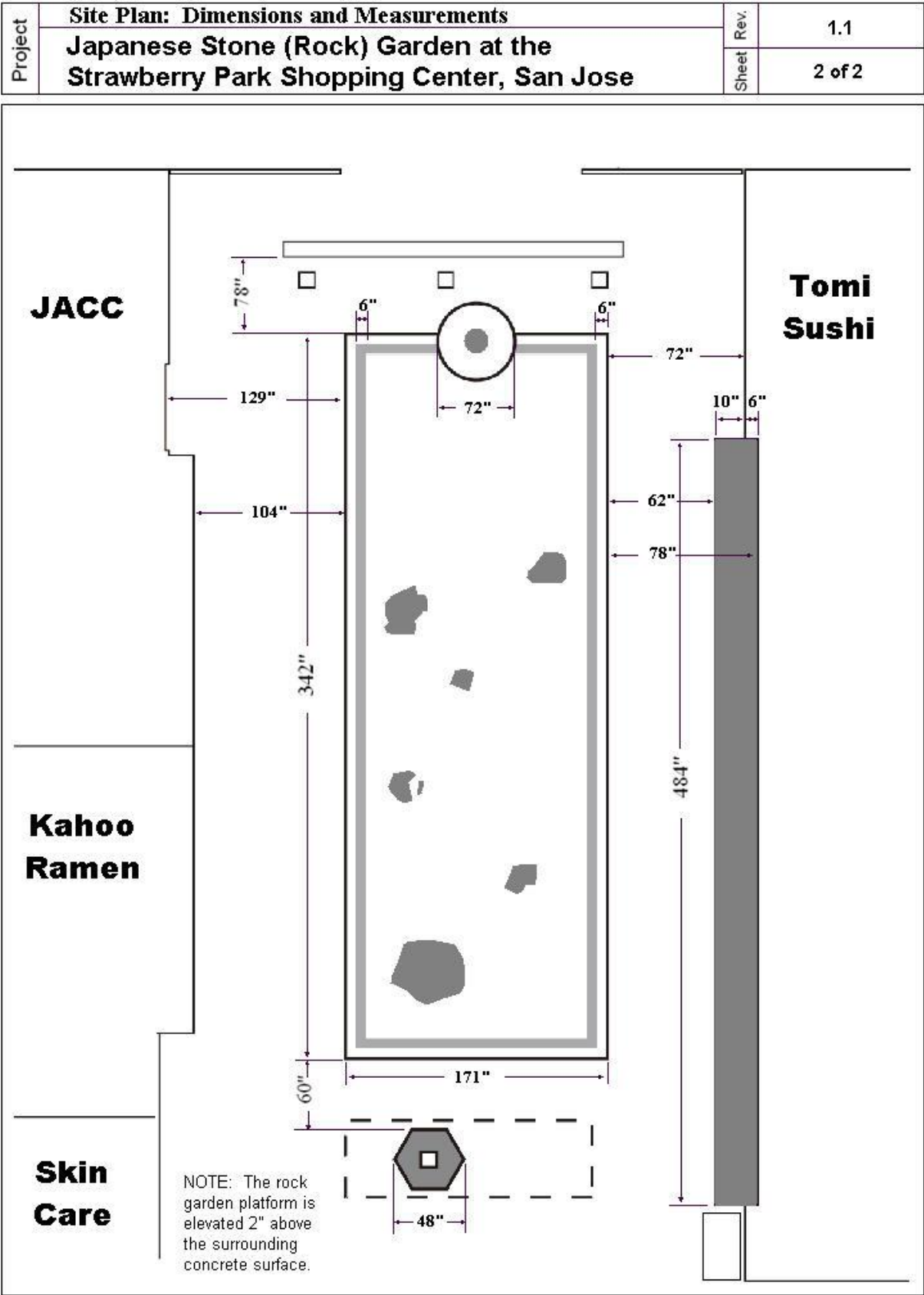

5. IMAGE PHOTOS



6. ASSUMPTIONS & REQUIREMENTS

- The Landlord's permission and agreement must be obtained. [DONE]
- Necessary funding must be secured. [DONE]
- Necessary funds (\$20K) must be donated.

7. DONATIONS & BRONZE PLAQUES

Two (2) bronze plaques will be placed on both side of the entry gate to the Rock Garden. One will describe what the Japanese Rock Garden; and the other will list the names of people & businesses who contributed to build the Garden. Names of anyone who donated more than \$100 will be displayed in appropriate sizes corresponding to the donated amount.



Example of Bronze Plaque

8. CONTACTS

San Jose "Japanese Rock Garden" Project
c/o Japanese Art & Cultural Center
4334 Moorpark Ave.
San Jose, CA 95129
Tel: (408)418-3535
Email: aki@jpnarts.org
Web: www.jpnarts.org

Akihiro Omi, Executive Director
Jun Shinagawa, Fundraising Chairman
Kei Noguchi, Fundraising Coordinator
Chieko Nishino, Public Relations Coordinator

San Jose 'Japanese Rock Garden'

DONATION FORM

To support the Japanese Rock Garden and its ideals and purposes, I hereby donate the following amount. I understand that the entire amount will be used for the construction of the Rock Garden and surrounding facilities, and any leftover money will be refunded proportionally.

Name (individual or business):					
Contact Information:					
Address _____					

Telephone () _____					
Email _____@_____					
Contact Person (if business) _____					
Donation Amount (circle one):					
\$100	\$200	\$300	\$500	\$1,000	Other amount (\$ _____)
How did you hear about the Japanese Rock Garden project?					
BaySpo	Sports-J	Flyer (Where?)
Other ()

If you donate more than \$100, your name(s) will be engraved on the bronze plaque to be displayed on the front gate of the Japanese Rock Garden. Size of the name(s) will correspond to the amount of the donation.

If you are writing a check, please make it payable to "JACC". We can also accept cash and credit cards. Please bring it to the Japanese Art & Cultural Center, 4334 Moorpark Ave., San Jose, CA 95129; (408)418-3535.

Thank you so very much for your generous support and contribution.